

# TURBOWING

By Wingmaster

A Division of Valley Chrome Plating  
(800) 926-6569

## Installation instructions for 70" Stand-up style Peterbilt

See Steps 1-3 assembly instructions before continuing!

4) Before raising the completed assembly to the top of the sleeper roof, place a blanket on the roof top to avoid paint damage.

5) Attach the rear triangle plates (item 6) to the support rails. (See Rear View B)

6) **VERY IMPORTANT!** Center the wing on the sleeper top to align brackets with factory roof supports.

7) Remove necessary items from the inside of the sleeper. The headliner may not need to be completely removed depending on the configuration of the sleeper. The headliner, courtesy lights and cabinets simply need to be loosened or moved to allow access to where the bolts will come through.

Peterbilt: Remove the cabinet on the passenger side at the rear of the sleeper. This makes it so that you can get in behind the headliner. Pull the headliner loose **NOT DOWN!**

8) **DRILLING.** Use a .397 clearance bit, goggles and a mask to prevent exposure to fiberglass particles.

a) Drill through REAR triangle plates and rear sleeper wall. (SEE Rear Detail A for Kenworth Detail B for Peterbilt)

b) Bolt rear triangle plates firmly in position.

c) Drill through the TOP of the sleeper using the holes in the brackets as a guide. Be sure to drill through the inner roof stiffener

d) Bolt the brackets in place according to:  
DETAIL A for Kenworth or  
DETAIL B for Peterbilt, use extra washers as needed to accommodate varying roof thicknesses. Snug the nuts till the rubber begins to compress. **DO NOT OVERTIGHTEN!!**

9) Reassemble interior.

10) Use window or metal cleaner and a soft lint free cloth to remove any fingerprints.

### Part # 70700

Item	Qty	Description
1	2	Rear Leg
2	2	Support Rail 28"
3	2	Triangle plates 5.25x6"
4	8	3/8" x 1" Bolt
5	4	3/8" x 1.5" x 3" Rubber pads
6	26	3/8" Flat washer
7	14	3/8" Self locking nut
8	4	3/8" x 1-1/4" Bolt
9	4	5/16" Rubber Washers
10	2*	1/8" x 1" 6" Backing plate
11	2	Bolt Plate "T" 4-1/16"

\* = Parts required for Kenworth installation only

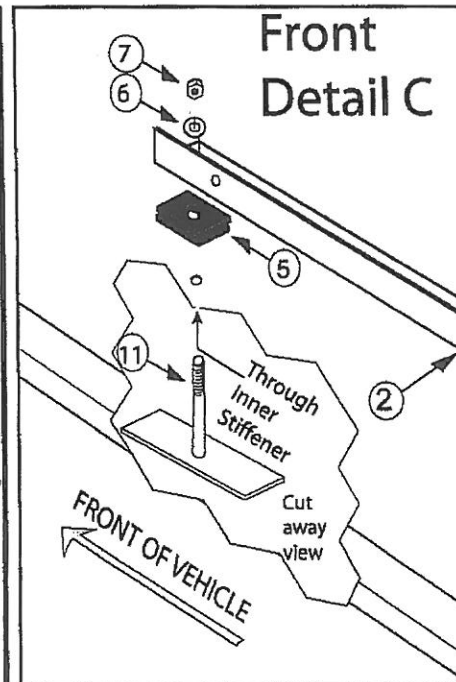

### Triangle Plates Exterior Item 6

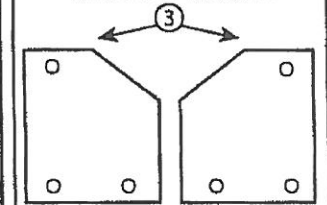

5.25" x 6"



Orient Toward Center

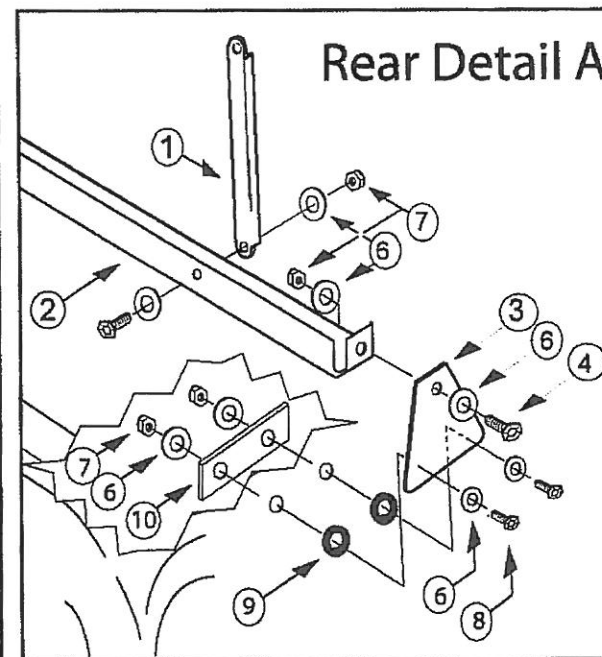

# TURBOWING

By Wingmaster

A Division of Valley Chrome Plating

(800) 926-6569

## Part # ★★711

Item	Qty	Description	Item	Qty	Description
1	1	Wing body	14	*	3/8" x 1-1/4" Bolt
2	2	Front "T" bracket & rubber	15	*	5/16" Rubber Washers
3	2	Rear "T" bracket & rubber	16	*	3/8" x 3-1/2" Bolt
4	2	Rear Leg	17	*	1/8" x 1" 6" Backing plate
5	2	Support Rail	18	*	Bolt Plate "T" 4-1/16"
6	2	Triangle plates	19	*	5/16" x 1" Bolt
7	8	5/16" x 1-1/2" Bolt	20	*	3/8" x 1-1/2" 6" rubber pad
8	8	5/16" lock washer	21	*	1/8" x 1-1/2" 6" Al. plate
9	8*	5/16 flat washer	22	*	3/8" X 3" Bolt
10	8*	3/8" x 1" Bolt	23	*	1" x 3" aluminum spacer
11	4*	3/8" x 1.5" x 3" Rubber pads	24	*	3/8" X 2-3/4" Bolt
12	28*	3/8" Flat washer	25	*	5/16" rivnut
13	14*	3/8" Self locking nut	26	*	Rivnut tool

\* These Items/ quantities will vary per sleeper

## ASSEMBLY INSTRUCTIONS

- Assemble front legs, rear legs and support rails as shown in Detail A. Front legs should be fully tightened (rubber pad slightly bulging). Leave rear brackets finger tight for adjustment in later steps. Do NOT attach the rear triangle plates at this time.
- To assure support rails will lie flat on the cab roof, adjust wing and brackets as described below:
  - Set the assembled wing on its brackets on a flat surface.
  - The rear brackets have slotted holes allowing for adjustment. Move the rear legs as necessary, forward or backward, until the support rails lie flat.
  - Square up the brackets by measuring equal distances across the corners of the support rails (in an X pattern).
  - Once all adjustments have been completed to assure rails are lying flat and square, tighten all bolts completely.
- Peel plastic coating from wing and brackets. Use a butane lighter or torch to remove any plastic burs from around rivets or screw heads.

**IMPORTANT!** See steps 4 through the end on sleeper specific instruction sheet packaged separately.

## Detail A

