



(A LIVERNE Company)

1200 E. Birch St.

Brandon, SD 57005

206760

FREIGHTLINER CASCADIA

2008-CURRENT

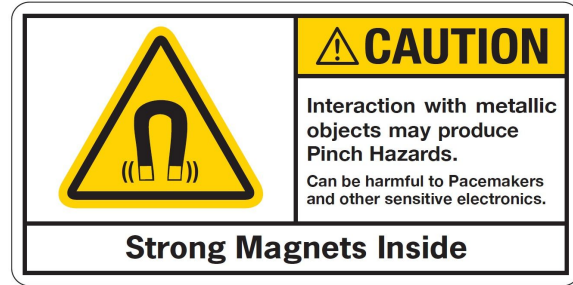

INSTALLATION INSTRUCTIONS

READ THE INSTRUCTIONS COMPLETELY AND CHECK TO MAKE SURE THAT ALL OF THE REQUIRED PARTS ARE ON HAND BEFORE STARTING THE INSTALLATION.

1. INSERT THE BRACKET MOUNTING TUBES (ITEM #4), INTO THE TOW HOOK RECEIVERS ON THE TRUCK. AND INSTALL THE MOUNTING BRACKET SPACER (ITEM #6), 3/4" LOCK WASHER (ITEM #20) AND THE 3/4" X 2" HEX BOLT (ITEM #10) ON TO THE INSIDE END OF THE MOUNTING TUBES.
2. USING THE 5/8" X 7/8" SHOULDER BOLTS (ITEM #12), .630 X 1.25 X .040 X .082 BELLEVILLE WASHERS (ITEM #18) AND 1/2"-13 NYLOCK NUTS (ITEM #15), ATTACH THE MOUNTING BRACKETS (ITEM #2 & #3) TO THE OUTSIDE OF THE GUARD USING THE BOTTOM HOLES. TIGHTEN TO 65 FOOT POUNDS.
3. OPEN UP THE BRACKETS AND WITH HELP, INSTALL THE GRILLE GUARD ASSEMBLY ONTO THE MOUNTING BRACKET BARS.
4. INSTALL THE 3/4"-10 X 3" BOLTS (ITEM #9) AND THE 3/4" LOCK WASHERS (ITEM #20) THROUGH THE FACE OF THE BRACKETS AND INTO THE MOUNTING BRACKET TUBES (ITEM #4). TIGHTEN THE BOLTS. **(NOTE: WHEN TIGHTENING THE BOLTS THE BRACKETS WILL HAVE A TENDENCY TO ROTATE. TO KEEP THE BRACKET FROM ROTATING, HOLD THE BOTTOM OF THE MOUNTING BRACKET WITH CRESENT WRENCH.)**
5. USING THE 5/8"-11 X 1-3/4" BOLTS (ITEM #11), AND 5/8"-11 NYLOCK NUTS (ITEM #14), AND 5/8" FLAT WASHER (ITEM #17), ATTACH MAGNET BRACKET ASSEMBLIES (ITEMS #5, #7, #8, #13, #16, & 19) TO THE MOUNTING BARS OF THE GRILLE GUARD, AS SHOWN IN *fig 1*.
6. CLOSE THE MOUNTING BRACKETS ON THE LATCH BUSHINGS. CHECK THAT THE MAGNETS ARE LINING UP WITH THE MAGNET PADS ON THE MOUNTING BRACKETS.

(NOTE: MAGNETS AND BRACKETS ARE PRE ASSEMBLED, SOME ADJUSTMENT MAY BE NECESSARY AFTER THE GRILLE GUARD IS INSTALLED ON THE TRUCK.)



(A LIVERNE Company)

1200 E. Birch St.

Brandon, SD 57005

NOTE: AFTER THE FIRST 1000 MILES, CHECK THE 3/4"-10 HEX MOUNTING BOLTS FOR LOOSENESS AND RETORQUE IF NECESSARY.

SERVICE PARTS LIST

ITEM	PART NO.	QTY	DESCRIPTION
1	VARIES	1	GUARD – TUBULAR, 3”
2	206802	1	MOUNTING BRACKET – LH, ZP
3	206803	1	MOUNTING BRACKET – RH, ZP
4	205811	2	BRACKET MOUNTING BAR – ZP
5	206519	2	MAGNET BRACKET, ZP
6	549495	2	MOUNTING BRACKET SPACER
7	109931	2	MAGNET-60MM, 200 LBS. N38, CSK
8	109932	2	RUBBER WASHER – 1.50OD X 0.344”ID X 0.094T
9	108987	2	SCREW – HEX HEAD, 3/4”-10 X 3”, ZP
10	108989	2	SCREW – HEX HEAD, 3/4”-10 X 2”, ZP
11	100175	2	SCREW-HEX HEAD, 5/8”-11 X 1- 3/4”, ZP
12	108968	2	BOLT – SHOULDER, 5/8” X 7/8”
13	109890	2	SCR-FSHCS, 1/4-20 X 1-1/4”, ZP
14	107435	2	NUT-NYLOCK, 5/8-11, ZP
15	105654	4	NUT – NYLOCK, 1/2”-13, ZP
16	102375	2	NUT-NYLOCK, 1/4-20, ZP
17	100147	2	FLAT WASHER, 5/8”, ZP
18	108969	4	WASHER – BELLEVILLE, .630 X 1.25 X .040 X .082
19	100034	2	WASHER – FLAT, 1/4”, ZP
20	101402	4	WASHER – LOCK, 3/4”, ZP
21	102500	4	TUBE INSERT – 3” (ON CERTAIN MODELS)
22	100252	1	SERIAL NUMBER DECAL

SERVICE PARTS DRAWING

MODEL NO. - 206760

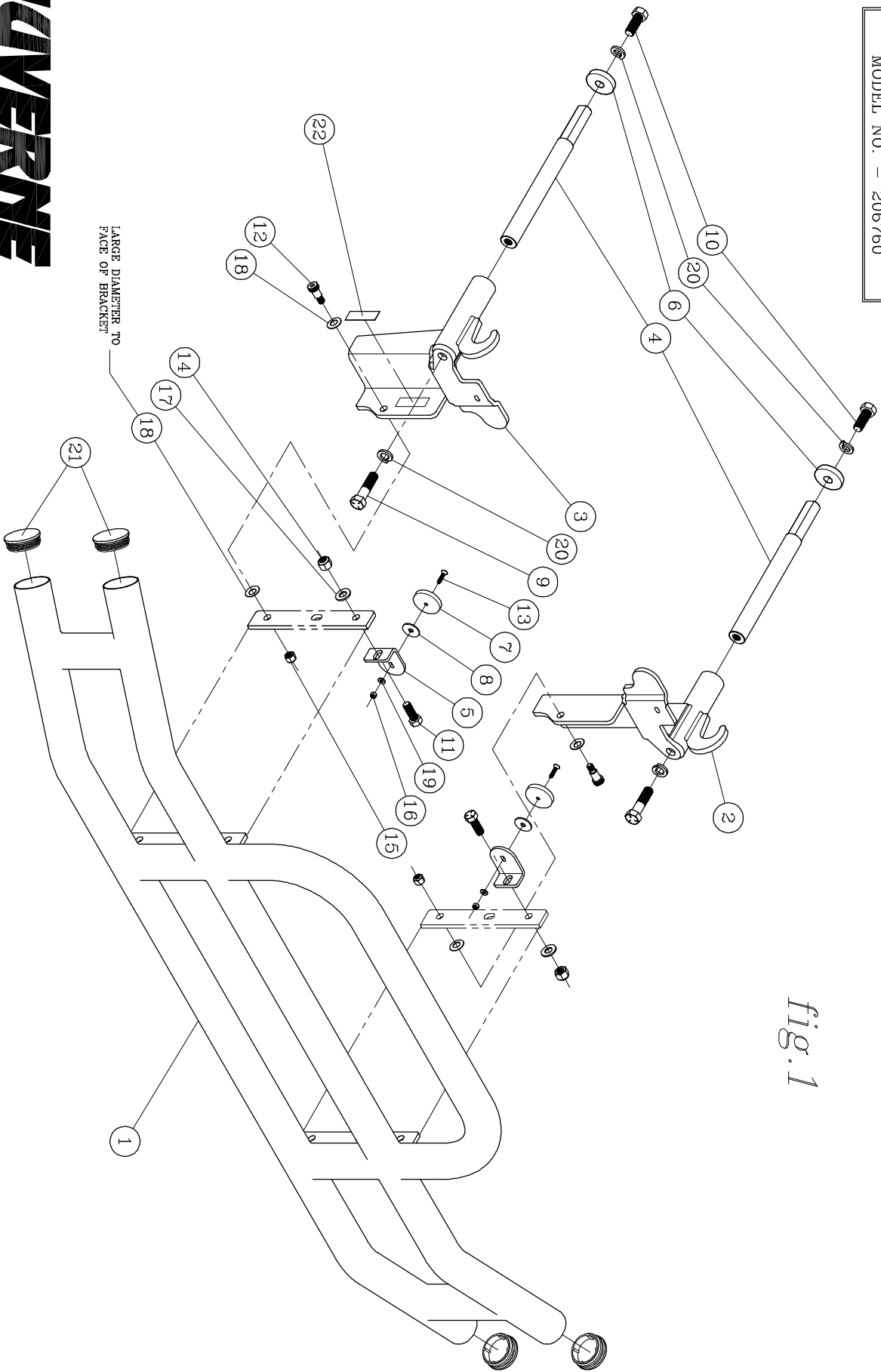

fig. 1



(A LUVERNE Company)

1200 E. Birch St. Brandon, SD 57005