



INSTALLATION INSTRUCTIONS FOR MOUNTING

LUVERNE GUARD WITH THE FOLLOWING MODEL NO.:
205500 & 205501/205560

1991 - 2003 FREIGHTLINER CLASSIC TRACTORS (NO DRILL)
2004 - 2006 FREIGHTLINER CLASSIC TRACTORS (DRILLING REQUIRED)
2007 - CURRENT FREIGHTLINER CLASSIC TRACTORS (DRILLING REQUIRED)

1. READ THE INSTRUCTIONS COMPLETELY AND CHECK TO MAKE SURE THAT ALL OF THE REQUIRED PARTS ARE ON HAND BEFORE STARTING THE INSTALLATION. THE CARTON SHOULD CONTAIN:

- (1) GUARD PACKAGE
 - (1) GUARD ASSEMBLY
- (1) MOUNTING BRACKET PACKAGE
 - (1) MOUNTING BRACKET, RH
 - (1) MOUNTING BRACKET, LH
 - (1) HARDWARE PACKAGE

REFER TO SHEETS #1, #2 & #3 FOR GUARD ASSEMBLY & INSTALLATION INSTRUCTIONS 2-8

2. 1991 - 2003 LOOSEN AND REMOVE THE TWO BOLTS TOP AND BOTTOM IN LINE WITH EACH OTHER ON ONE SIDE OF THE VEHICLE. (SEE FIG. 1)

2004 - 2006 REMOVE THE BOLT FROM THE TOP HOLE ON THE INSIDE OF THE TOW HOOK HOLE. INSTALL THE TOP BOLT. THE BOTTOM HOLE WILL HAVE TO BE DRILLED FOR THE BOTTOM BOLT. (SEE FIG. 1)

2007 - CURRENT REMOVE THE BOLT FROM THE TOP HOLE ON THE INSIDE OF THE TOW HOOK HOLE. INSTALL THE TOP BOLT. THE BOTTOM HOLE WILL HAVE TO BE DRILLED FOR THE BOTTOM BOLT. (SEE FIG. 1)
3. INSTALL THE MOUNTING BRACKET (ITEM #2) OR (ITEM #3) FOR THAT SIDE, USING THE ½"-13 X 1-3/4" HEX HEAD SCREWS (ITEM #6) AND THE ½" SAE FLAT WASHERS (ITEM #12) IN THE TOP AND BOTTOM HOLE, AS SHOWN IN FIG. 1 & 2. HAND TIGHTEN ONLY AT THIS TIME.
4. REPEAT STEPS 2 & 3 FOR THE OPPOSITE SIDE.
5. INSTALL THE GUARD (ITEM #1) ONTO THE MOUNTING BRACKETS AND FASTEN WITH 5/8"-11" X 2" HEX BOLTS (ITEM #5), 9/16" FLAT WASHERS (ITEM #11), 1"OD HDPE WASHERS (ITEM #13) AND 5/8"-11 NYLOCK NUTS (ITEM #8).
6. SECURE THE TOP OF THE GUARD TO THE TOP OF THE MOUNTING BRACKETS WITH THE CLEVIS PINS (ITEM #14) AND THE HAIR PINS (ITEM #15)
7. SNUG UP THE 5/8"-11 NYLOCK NUTS SO THAT THE GUARD IS SNUG BUT WILL STILL ROTATE EASILY WHEN LOWERING THE GUARD TO OPEN THE HOOD. CHECK THAT THE GUARD IS CENTERED AND VERTICAL ON THE BUMPER AND THE MOUNTING BRACKETS ARE STRAIGHT UP AND DOWN. THEN TIGHTEN THE FOUR ½" BOLTS SECURING THE MOUNTING BRACKETS TO THE BUMPER. TIGHTEN TO 75 FOOT-POUNDS OF TORQUE.

8. INSTALL THE 1/2"-13 X 1" HEX BOLTS (ITEM #7) AND THE 1/2"-13 NYLOCK NUTS (ITEM #9) THAT ARE USED AS STOPS, WHEN LOWERING THE GUARD. ALIGN A FLAT SIDE OF THE BOLT HEAD WITH THE FLAT SURFACE OF THE MOUNTING TAB ON THE GUARD AND TIGHTEN THE NUT.

SERVICE PARTS LIST

ITEM	PART NO.	QTY	DESCRIPTION
1	205500	1	GUARD - SST
1	205501	1	GUARD - BLACK
2	205561	1	MOUNTING BRACKET - RH, ZP
3	205562	1	MOUNTING BRACKET - LH, ZP
4	102500	4	INSERT - FINISH, 3"
5	100144	2	HEX HEAD SCREW - 5/8"-12 X 2", ZP
6	100870	4	HEX HEAD SCREW - 1/2"-13" X 1-3/4", ZP
7	100085	2	HEX HEAD SCREW - 1/2"-13 X 1", ZP
8	107435	2	NUT - NYLOCK, 5/8"-11
9	105654	2	NUT - NYLOCK, 1/2"-13
10	100123	2	NUT - HEX FLANGE, 1/2"-13, ZP
11	100140	4	FLAT WASHER - 9/16", ZP
12	104995	4	FLAT WASHER - SAE, 1/2", ZP
13	102149	4	HDPE WASHER - 1OD X 5/8ID X 1/32"
14	107438	2	PIN - CLEVIS, 5/8" X 2"
15	100159	2	HAIR PIN, 9GA., ZP
16	100252	1	LOGO/SERIAL NO. DECAL

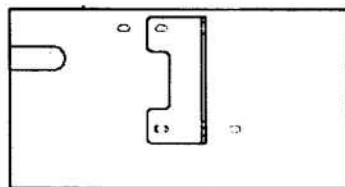

NO DRILL

1991 - 2003

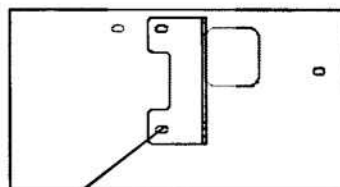

DRILL THIS HOLE

2004 - 2006

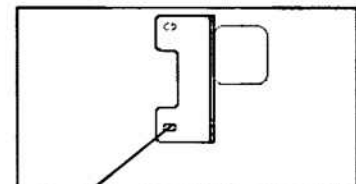

DRILL THIS HOLE

2007 - CURRENT

SERVICE PARTS DRAWING

MODEL NO. - 2055660

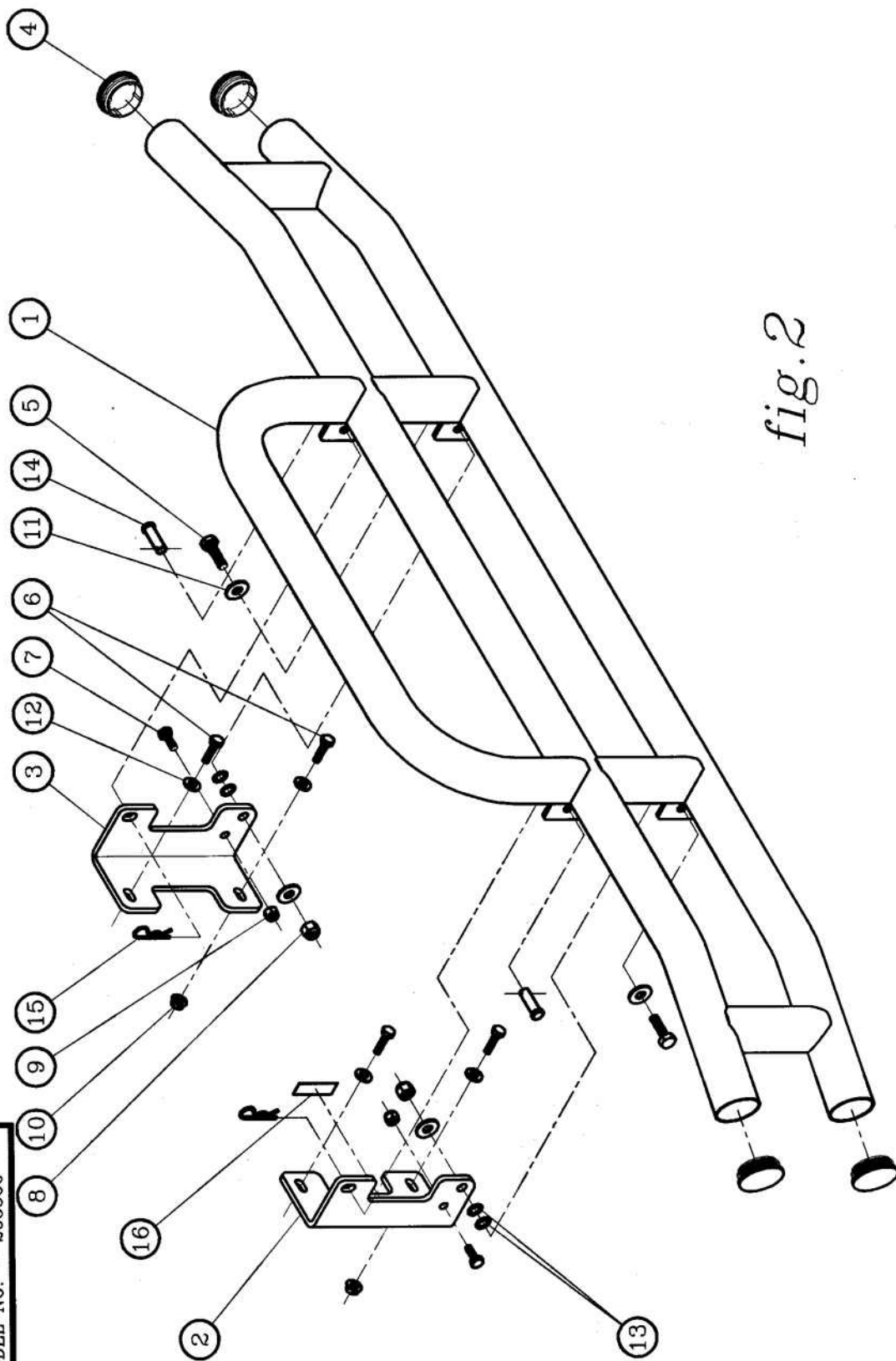

fig.2

LIVERNE
TRUCK EQUIPMENT

(A LIVERNE Company)
1200 E. Birch St.
Evanston, SD 57005