



(A LIVERNE Company)

1200 E. Birch St.

Brandon, SD 57005

CLASS 8 KENWORTH T600 (1985-2007)

INSTALLATION INSTRUCTIONS

READ THE INSTRUCTIONS COMPLETELY AND CHECK TO MAKE SURE THAT ALL OF THE REQUIRED PARTS ARE ON HAND BEFORE STARTING THE INSTALLATION.

1. LOOSEN AND REMOVE THE TWO BOLTS FROM ONE SIDE OF THE FACTORY BUMPER. DO NOT REMOVE ALL FOUR AT THE SAME TIME.
2. INSTALL THE MOUNTING BRACKETS (ITEMS #3 & #4), USING THE M12 X 65mm HEX BOLTS (ITEM #11), 1/2" FLAT WASHER (ITEM #12), AND 1/2" CLIPPED FLAT WASHER (ITEM #13) AS SHOWN IN FIG. 1. HAND TIGHTEN ONLY AT THIS TIME, TO BE ADJUSTED LATER.
3. REPEAT FOR OPPOSITE SIDE.
4. INSTALL THE GUARD (ITEM #1) ONTO THE MOUNTING BRACKETS AND FASTEN WITH 5/8-11 X 2" HEX BOLTS (ITEM #10), 9/16" FLAT WASHERS (ITEM #14), 5/8" NYLON WASHERS (ITEM #15) AND 5/8-11 NYLOCK NUTS (ITEM #6).
5. SECURE THE TOP OF THE GUARD TO THE TOP OF THE MOUNTING BRACKETS WITH THE CLEVIS PINS (ITEM #7) AND THE HAIR PINS (ITEM #8)
6. SNUG UP THE 5/8-11 NYLOCK NUTS SO THAT THE GUARD IS SNUG BUT WILL STILL ROTATE EASILY WHEN LOWERING THE GUARD TO OPEN THE HOOD. CHECK THAT THE GUARD IS CENTERED ON THE BUMPER AND THE MOUNTING BRACKETS ARE STRAIGHT UP AND DOWN. THEN TIGHTEN THE FOUR M12 X 65mm HEX BOLTS SECURING THE MOUNTING BRACKETS TO THE BUMPER. TIGHTEN TO 75 FOOT-POUNDS OF TORQUE.
7. INSTALL THE 1/2-13 X 1" HEX BOLTS (ITEM #9) AND THE 1/2-13 NYLOCK NUTS (ITEM #5) THAT ARE USED AS STOPS WHEN LOWERING THE GUARD. ALIGN A FLAT SIDE OF THE BOLT HEAD WITH THE FLAT SURFACE OF THE MOUNTING TAB ON THE GUARD AND TIGHTEN THE NUT.

LUPERNE

TRUCK EQUIPMENT

(A LUPERNE Company)

1200 E. Birch St.

Brandon, SD 57005

CLASS 8 KENWORTH T600 (1985-2007)

SERVICE PARTS LIST

ITEM	PART NO.	QTY	DESCRIPTION
1	205500	1	GUARD – TUBULAR, 3” SST
	205501		GUARD – TUBULAR, 3” BLACK
2	102500	4	INSERT – FINISH, BLACK, 3”
3	205662	1	MOUNTING BRACKET – LH, ZP
4	205664	1	MOUNTING BRACKET – RH, ZP
5	105654	2	NUT – NYLOCK, 1/2-13, ZP
6	107435	2	NUT – NYLOCK, 5/8-11, ZP
7	107438	2	PIN – CLEVIS, 5/8 X 2
8	100159	2	PIN – HAIR , 9GA., ZP
9	100085	2	SCREW – HEX HEAD, 1/2-13 X 1, ZP
10	100144	2	SCREW – HEX HEAD, 5/8-12 X 2, ZP
11	104987	4	SCREW – HEX HEAD, M12 X 65mm, ZP
12	100118	2	WASHER – FLAT, 1/2, SAE, ZP
13	103779	2	WASHER – FLAT, 1/2, SAE, ZP, CLIPPED
14	100140	4	WASHER – FLAT, 9/16, USS, ZP
15	102149	4	WASHER – NYLON, 1 OD X 5/8 ID X 1/32

SERVICE PARTS DRAWING

MODEL NO. - 205660

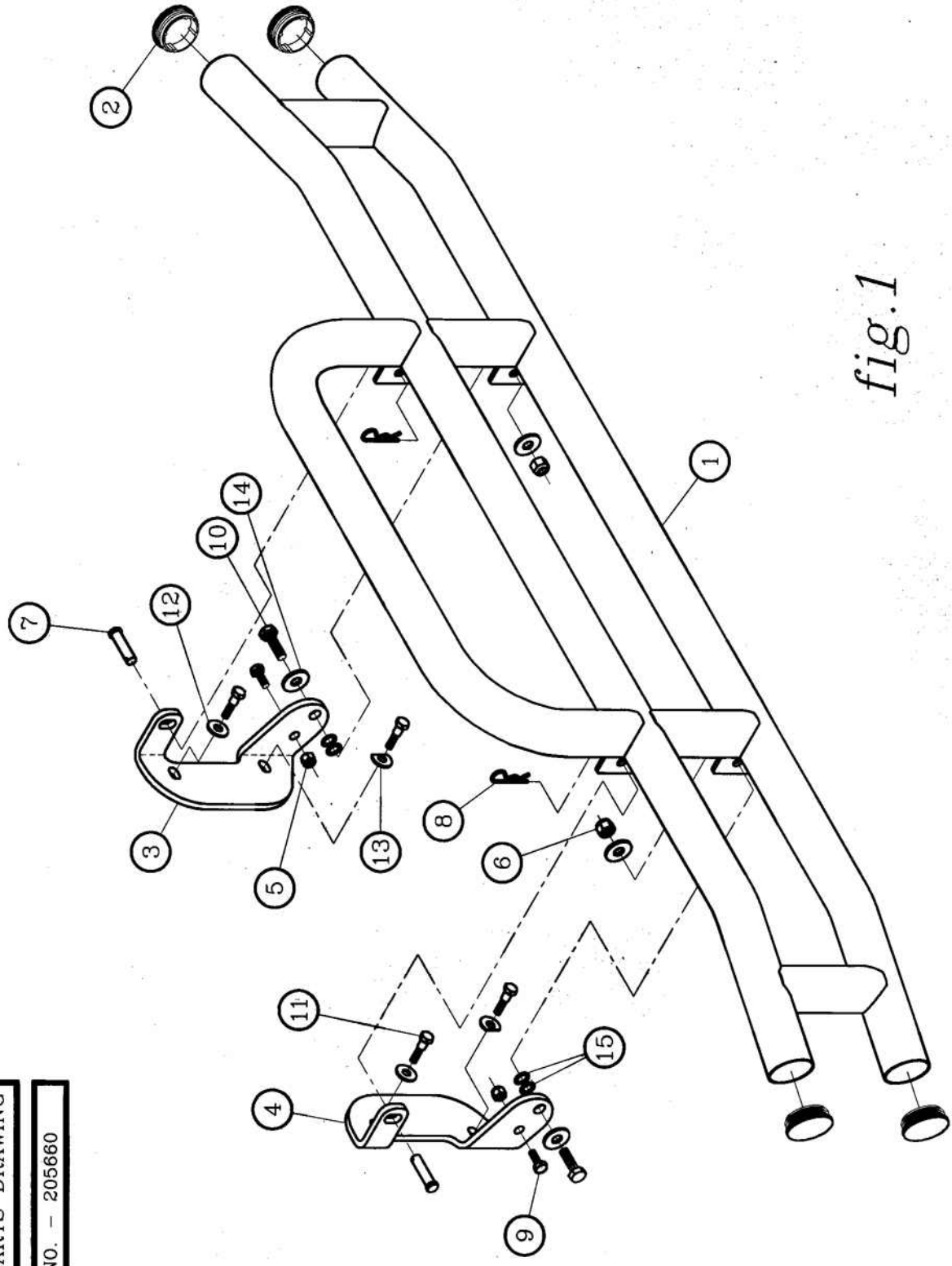

fig.1

LOVERNE
TRUCK EQUIPMENT

(A LOVERNE Company)
1200 E. Birch St.
Brandon, SD 57005