



(A LIVERNE Company)

1200 E. Birch St.

Brandon, SD 57005

205720

PETERBILT 386 / KENWORTH T-660 2006-CURRENT / 2007-CURRENT

INSTALLATION INSTRUCTIONS

READ THE INSTRUCTIONS COMPLETELY AND CHECK TO MAKE SURE THAT ALL OF THE REQUIRED PARTS ARE ON HAND BEFORE STARTING THE INSTALLATION.

1. INSERT THE BRACKET MOUNTING BARS (ITEM #4), INTO THE TOW HOOK RECEIVERS ON THE TRUCK. YOU MUST USE THE VEHICLE SUPPLIED 1" DIA. PINS (OR EQUIVALENT) TO SECURE THE BRACKET MOUNTING BARS IN THE TOW HOOK RECEIVERS.
2. USING THE 5/8" X 7/8" SHOULDER BOLTS (ITEM #9), .630 X 1.25 X .040 X .082 BELLEVILLE WASHERS (ITEM #15) AND 1/2"-13 NYLOCK NUTS (ITEM #13), ATTACH THE MOUNTING BRACKETS (ITEM #2 & #3) TO THE OUTSIDE OF THE GUARD USING THE BOTTOM HOLES. TIGHTEN TO 65 FOOT POUNDS.
3. USING THE 5/16"-18 X 1-1/4" BUTTON HEAD SCREWS (ITEM #11), AND 5/16"-18 NYLOCK NUTS (ITEM #14), ATTACH THE RUBBER STOPS (ITEM #7) TO THE MOUNTING BRACKETS AS SHOWN IN FIG 1.
4. ASSEMBLE THE LATCHING HARDWARE – LATCH BUSHING (ITEM #6), BELLEVILLE WASHERS (ITEM #15), 1" OD X 5/8" ID X 1/16" NYLON WASHERS (ITEM #17), MOUNTING BRACKET LATCH (ITEM #5), 1/2"-13 X 3" HEX HEAD BOLT (ITEM #10), 7/16" WASHER (ITEM #12) AND 1/2"-13 HEX NYLOCK NUT (ITEM #13) TO THE MOUNTING BAR ON THE GRILLE GUARD. LEAVE LOOSE AT THIS TIME. **(NOTE: APPLY A SMALL AMOUNT OF GREASE TO THE SLOT AREA OF THE MOUNTING BRACKET LATCH TO AID IN SLIDING.)**
5. CLOSE THE MOUNTING BRACKETS ON THE LATCH BUSHINGS. CHECKING THAT THE RUBBERS ARE SEATED ON THE LATCH BUSHINGS AND TIGHTEN THE 1/2"-13 HEX BOLTS.
6. OPEN UP THE BRACKETS AND WITH HELP, INSTALL THE GRILLE GUARD ASSEMBLY ONTO THE MOUNTING BRACKETS.

REVISED 27OCT15 LVL E
REVISED 26AUG15 LVL D
REVISED 05FEB13 LVL C
REVISED 05SEP11 LVL B
REVISED 10JUN11 LVL A
PAGE 1 OF 3 15SEP08



(A LIVERNE Company)

1200 E. Birch St.

Brandon, SD 57005

7. INSTALL THE 7/8"-9 X 3" BOLTS (ITEM #8) AND THE 7/8" LOCK WASHERS (ITEM #18) THROUGH THE FACE OF THE BRACKETS AND INTO THE MOUNTING BRACKET BARS (ITEM #4). TIGHTEN THE BOLT TO 150 FOOT POUNDS. (NOTE: WHEN TIGHTENING THE BOLTS THE BRACKETS WILL HAVE A TENDENCY TO ROTATE. TO KEEP THE BRACKET FROM ROTATING, INSERT A BAR IN THE TOW HOOK AND UNDER (RH) OR OVER (LH) THE SQUARE TUBE TO MAINTAIN A STRAIGHT UP AND DOWN POSITION.)

NOTE: AFTER THE FIRST 1000 MILES, CHECK THE 7/8"-9 HEX MOUNTING BOLTS FOR LOOSENESS AND RETORQUE IF NECESSARY.

SERVICE PARTS LIST

ITEM	PART NO.	QTY	DESCRIPTION
1	VARIABLES	1	GUARD – TUBULAR, 3"
2	206728	1	MOUNTING BRACKET – LH, ZP
3	206729	1	MOUNTING BRACKET – RH, ZP
4	205737	2	BRACKET MOUNTING BAR – ZP
5	205792	2	MOUNTING BRACKET LATCH – ZP
6	108972	2	LATCH BUSHING – ZP
7	205793	2	MOUNTING BRACKET STOP
8	107873	2	SCREW – HEX HEAD, 7/8"-9 X 3", ZP
9	108968	2	BOLT – SHOULDER, 1/2" X 5/8"
10	109472	2	SCREW – HEX HEAD, 1/2"-13 X 3", ZP
11	108971	2	SCREW – HEX HEAD, 5/16"-18 X 1-1/4", SST
12	100081	2	WASHER-FLAT, 7/16", ZP
13	105654	4	NUT – NYLOCK, 1/2"-13, ZP
14	102380	2	NUT – NYLOCK, 5/16"-18, ZP
15	108969	10	WASHER – BELLEVILLE, .630 X 1.25 X .040 X .082
16	102149	2	WASHER – 1" OD X 5/8" ID X 1/16", HDPE
17	107874	2	WASHER – LOCK, 7/8", ZP
18	102500	4	TUBE INSERT – 3" (ON CERTAIN MODELS)
19	100252	1	SERIAL NUMBER DECAL

REVISED 27OCT15 LVL E
 REVISED 26AUG15 LVL D
 REVISED 05FEB13 LVL C
 REVISED 05SEP11 LVL B
 REVISED 10JUN11 LVL A
 PAGE 2 OF 3 15SEP08

VEHICLE TOW HOOK PINS

SERVICE PARTS DRAWING
MODEL NO. - 205720

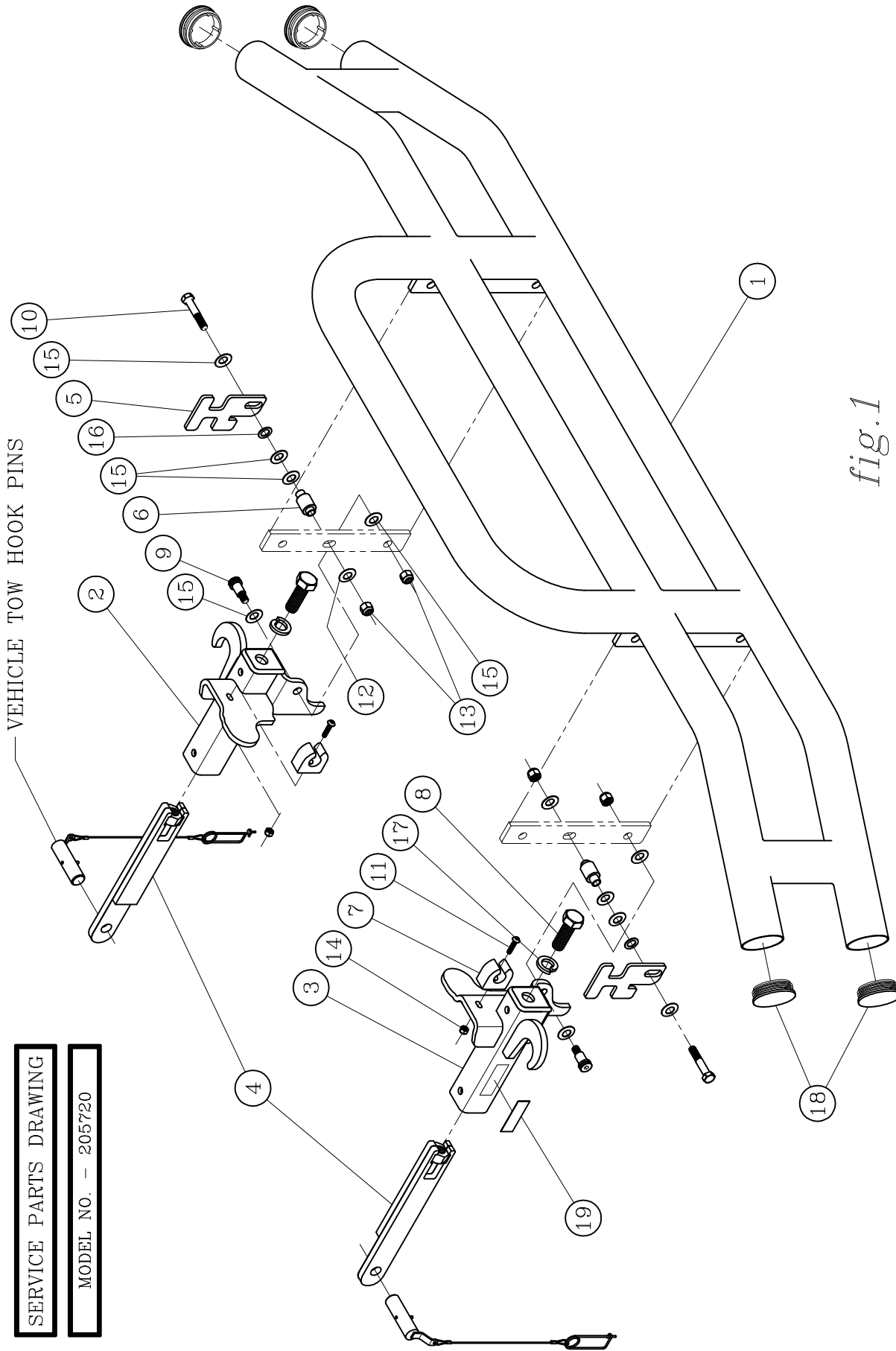

fig.1

REVISED 27OCT15 LVL E
REVISED 26AUG15 LVL D
REVISED 05FEB13 LVL C
REVISED 05SEP11 LVL B
REVISED 10JUN11 LVL A

205726 SHEET 3 OF 3 17SEP08

LIVERNE
(A LIVERNE Company)
1200 E. Birch St.
Brendon, SD 57806