

PLEASE READ THE INSTRUCTIONS COMPLETELY BEFORE BEGINNING

INSTALLATION INSTRUCTIONS

- 1- ARRANGE THE LOUVER BARS AND SURROUND PIECES ON A FLAT SURFACE. THE PART NUMBERS FOR THE SURROUND ARE ETCHED ON THE PARTS AND SHOULD BE ARRANGED AS FOLLOWS: CL7223021-U05 IS THE BOTTOM, CL7223021-U06 IS THE TOP, CL7223021-U02 IS THE CENTRAL LOUVERS SUPPORT, CL7223021-U01 IS THE LOUVERS STYLE BARS AND CL7223020-U04 IS DRIVER AND PASSENGER SIDE. YOU SHOULD ALSO HAVE ONE CL7223021-U03.
- 2- REMOVE THE FACTORY INNER GRILL, SCREEN AND THE LOGO HOOD PULL, THE SCREEN WILL BE REINSTALLED LATER.
- 3- TAKE THE -U06 PART, PEEL THE PVC FILM AWAY FROM THE HOLES AND AWAY FROM THE TOP CENTER AREA. **SEE SURFACE PREPARATION TO STICK 3M TAPE INSTRUCTIONS.**
- 4- THE -U06 PART LOWER CORNER HOLES MUST LINED UP WITH FACTORY HOLES. DRILL THE LOWER INNER HOLES AT $\phi 5/16"$ DIA.
- 5- TAKE THE CL7223020-U04 AND CL7223021-U03 PARTS PEEL THE PVC FILM COMPLETELY, INSTALL THE CL7223020-U04 BEHIND THE ALUMINIUM HOOD FRAME PART, USE 1 1/4"LG CARRIAGE BOLT AT EACH UPPER CORNER THEN INSERT CL7223021-U03 USING FLAT WASHERS AND HEX. NUT $\phi 1/4"$, USE 3/4"LG CARRIAGE BOLTS, FLAT WASHERS LOCK WASHERS AND HEX. NUTS $\phi 1/4"$, IN THE LOWER INNER HOLES OF THE CL7223020-U06 PART & THE ALUMINIUM HOOD FRAME PART. DO NOT TIGHTEN.
- 6- TAKE THE CL7223021-U05 PART, PEEL THE PVC FILM AWAY FROM THE HOLES, INSTALL IT IN FRONT OF THE HOOD LOWER FRAME PART, CORNER HOLES OF CL7223020-U04, HOOD FRAME AND CL7223021-U05 MUST BE ALINED, USED IN THE CORNER HOLES AND CL7223020-U04 SIDE HOLES 1 1/4"LG CARRIAGE BOLTS, FLAT WASHER, HEX. NUT 1/4", LOCK WASHER & HEX. NUT 1/4". DO NOT TIGHTEN.
- 7- TAKE THE CL7223021-U02 PEEL THE PVC COMPLETELY, SLIDE THE BUTTOM BETWEEN THE CL7223021-U05 AND THE HOOD FRAME, USE 3/4"LG CARRIAGE BOLTS, FLAT WASHERS, LOCK WASHERS AND HEX. NUTS $\phi 1/4"$ IN THE 4TH REMAINING HOLES, TIGHTEN ALL INSTALLED BOLTS TILL NOW.
- 8- TAKE THE LOUVER STYLE BARS (CL7223021-U01), PEEL THE PVC FILM AWAY FROM ENDS AND CENTER BOLT HOLES. BEGIN BY THE UPPER LOUVER STYLE BAR. INSERT CARRIAGE BOLTS #10-32X1/2"LG THROUGH THE FLAT WASHER $\phi 1/4"$ AND INSERT THOSE PARTS IN THE UPPER LEG OF THE CL7223020-U04 PART THEN INSERT THE FLAT WASHER AND LOCK NUTS #10-32 FULLY TIGHTEN ALL BOLTS.
- 9- TAKE THE LOUVER STYLE BARS (CL7223021-U01), PEEL THE PVC FILM AWAY FROM ENDS AND CENTER BOLT HOLES. INSTALL THE REMAINING LOUVER STYLE BARS FROM TOP TO BOTTOM. USE CARRIAGE BOLTS #10-32X1/2"LG, FLAT WASHER AND LOCK NUTS #10-32 FULLY TIGHTEN ALL BOLTS AFTER EACH LOUVER INSTALLATION. NOTE: THE BOTTOM LOUVER STYLE BAR MUST BE TIGHTEN FROM THE INSIDE OF THE HOOD.
- 10- TAKE THE PREVIOUSLY REMOVED GRILL. TAKE OFF THE VERTICAL BARS AND DISCARD THEM, RETAIN THE SCREEN AND IT'S SUPPORT.
- 11- TAKE THE SCREEN SUPPORT AND REDRILL THE THREADED HOLES AT $\phi 5/16"$ (.3125").
- 12- INSTALL THE SCREEN FROM THE INSIDE OF THE HOOD, SCREEN HOLES MUST BE ALINED WITH THE 1 1/4"LG CARRIAGE BOLTS.
- 13- INSTALL THE SCREEN SUPPORT PLACE THE REDRILLED HOLES FROM THE TOP AND ALINED WITH THE 1 1/4"LG CARRIAGE BOLTS, FINALLY INSERT LOCK WASHERS AND HEX. NUTS $\phi 1/4"$, FULLY TIGHTEN ALL BOLTS.

ATTENTION
BEFORE BEGINNING THE INSTALLATION OF YOUR NEW GRILL, ENSURE THAT THE KIT YOU HAVE RECEIVED MATCHES YOUR TRUCK MODEL

DRILL THE LOWER INNER HOLES

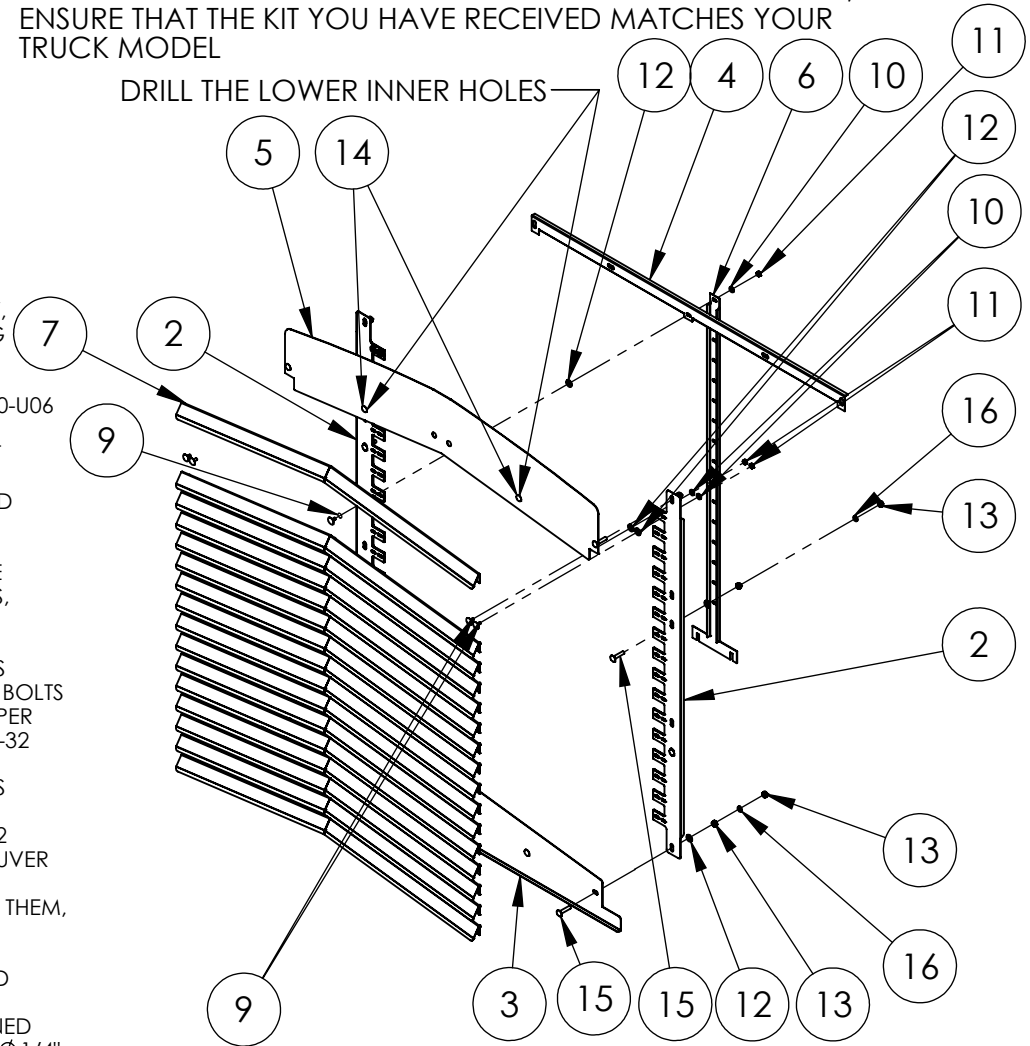

ITEM NO.	PART NUMBER	DESCRIPTION	QTY
1	M7223021CC	FRONT GRILL	1
2	-	PR7223020-U04	2
3	-	PR7223021-U05	1
4	-	PR7223021-U03	1
5	-	PR7223021-U06	1
6	-	PR7223021-U02	1
7	-	PR7223021-U01	16
8	K7223021BB	BOLTS KIT INCLUDES :	1
9	-	CARRIAGE BOLT 10-32NFX1/2"SS	80
10	-	FLAT WASHER ID# 10 X OD 1/2" SS	80
11	-	NYLON LOCK NUT #10-32NF SS	80
12	-	FLAT WASHER 1/4" SS	19
13	-	HEX NUT 1/4-20NC	22
14	-	CARRIAGE BOLT 1/4-20 X 3/4"LG	6
15	-	CARRIAGE BOLT 1/4-20 X 1 1/4"LG	8
16	-	LOCK WASHER 1/4" SS	14

TRUX ACCESSORIES

TITLE:
**FRONT GRILL W/16 LOUVER STYLE BARS
KENWORTH W900**

SIZE: **A** DWG. NO.: **TK-1003**

NAME	DATE	REV	DATE
P.W.	24-11-2008	PH1	-

SCALE: 1:12 WEIGHT: LBS SHEET: 1 OF 1