

VP 130013

389 Peterbilt - 14" Drop Visor Instructions

2007 & Newer Standard w/cab mounted mirrors - curved windshield

Read Entire Instruction Sheet Before Beginning

Safety Glasses	10mm Metric Wrench
Grinder	7/16" Wrench
Silicone or "Loctite®"	Phillips Head Screw Driver
Masking Tape	Window Cleaner and Paper Towels
3/8" Drill bit	

Steps:

- 1) Remove your current visor:
 - a) Note: You will need to reuse the bolts which go into the side of the cab at the ends of the visor.
- 2) Grind off the heads of the Huck bolts.
 - a) Hold the existing brackets in place and take your time grinding Huck heads. If you grind too fast or hard it will melt the paint around the head. It is recommended that you only grind a little bit at a time.
- 3) Drill out the "Huck" holes with a 3/8" diameter drill bit.
 - a) Drilling requires you to have a "drill-stop", if you do not have one wrap tape around the drill bit approximately one inch from the tip of the bit, this will prevent "Breaking through" and damaging the interior headliner.
- 4) Press the Rivnuts into the 3/8" holes. (See Side View illustration).

Note: Remove mirror support to install ear of visor over mirror bracket.
Insert Rivnuts, using Rivnet tool or Rivnut gun - install security Rivnuts without over torquing, causing damage to outer cab.
- 5) Install the mounting bracket per illustration. Once you feel the bolt "bottom out" STOP TIGHTENING.
- 6) Install the drivers side portion (Item 1) of the visor first.

Note: Install Rubber Washers between the cab and the mirror brackets.

 - a) Screw in a couple of turns the "side of cab bolts" through the holes in the end of the visor.
 - b) Start the machine screws into the outside bracket to temporarily hold it in position.
- 7) Repeat Step 6 with the passenger side.
- 8) Where the visors join together, screw in the top and bottom machine screws until finger-tight.
- 9) Align the visor by snugly tightening one of the truss head machine screws in each mounting bracket. Start from the outside of the cab and work toward the middle, one bolt per bracket at a time.
- 10) Remove the PVC coating from the visor.
- 11) Once the visor is in alignment, tighten the machine screws with the Nylock nuts.
- 12) Tighten all remaining bolts and machine screws. We recommend that you use silicone or Loctite® on each of the screws to prevent loosening from over the road use.
- 13) **Use lock washers on all bolts that mount directly to truck cab** to prevent loosening due to normal road vibrations.
- 14) Wipe away fingerprints with window cleaner.

VP130013 389 Peterbilt 14" Drop Visor

2007 & Newer Standard - W/Cab Mounted Mirrors - Curved Windshield

INSTALLATION INSTRUCTIONS

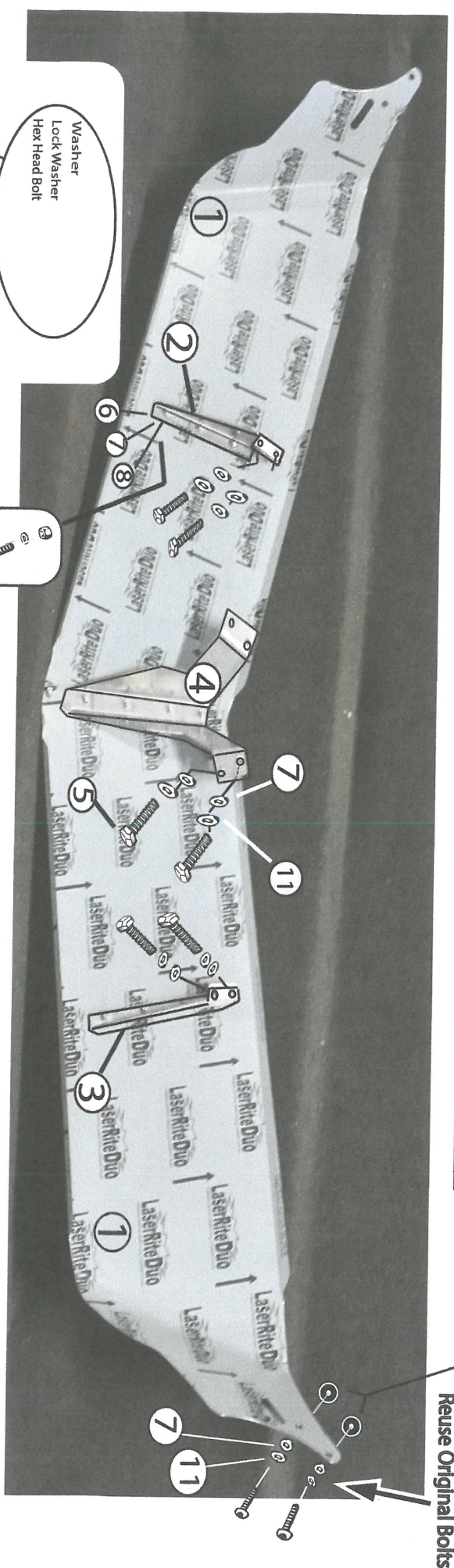

Washer
Lock Washer
Hex Head Bolt

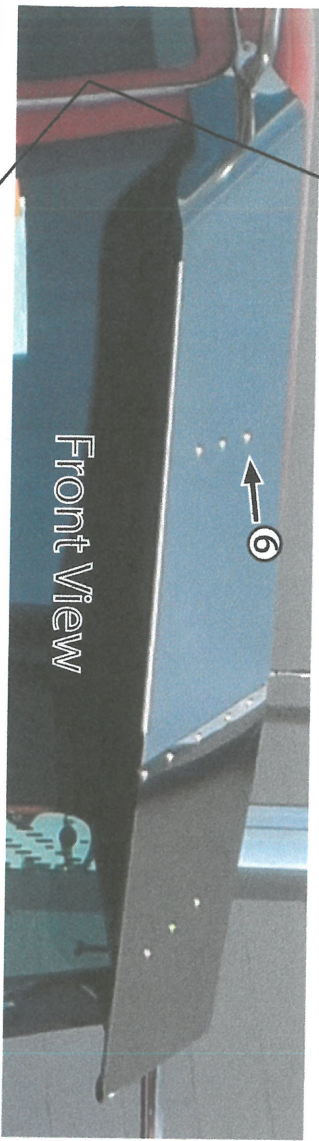

Front View

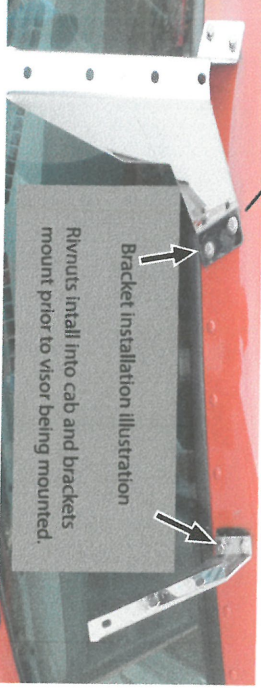

Tool included in hardware

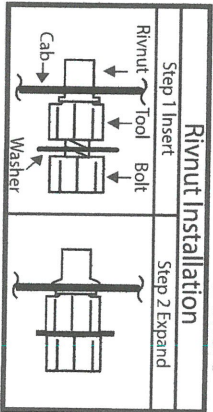

Item	QTY	Description	Size
1	2	Visor body Halve	13.5" x 35"
2	1	Outer Visor Brkt DS (VP130013-3)	3/4" x 10 x 1/4"
3	1	Outer Visor Brkt PS (VP130013-4)	3/4" x 10 x 1/4"
4	1	Center Visor Brkt(s) (VP130013-2)	9 - 1/4" x 15"
5	8	Hex Head Bolts	1/4" x 1"
6	11	Truss Head Machine Screws	1/4" x 3/4"
7	23	Washers	1/4"
8	11	Nylock Nuts	1/4"
9	8	Rivnuts	1/4"
10	1	Rivnut Tool	1/4"
11	12	Lock Washers	1/4"
12	4	Rubber Washers	1/4"

REVISION 10/15

Install Rubber Washers between cab and visor

Reuse Original Bolts